

ROUGH OPENING (R.O.) IS THE SUGGESTED R.O. IS 3/8" LARGER AROUND THE PERIMETER THAN THE NET FRAME DIMENSION (NFD) SHOWN IN THIS DRAWING.

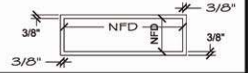

**EXTERIOR DOOR SPECIES & GLAD COLOR**

WOOD SPECIES: \_\_\_\_\_  
 PANEL CLAD COLOR: \_\_\_\_\_  
 GLASS: \_\_\_\_\_  
 EAGLE STD SPACER BAR COLOR: \_\_\_\_\_  
 DOOR THICKNESS: \_\_\_\_\_  
 THRESHOLD COLOR:  
 ALUM. CLEAR     BRONZE ANODIZED  
 Q-LON WEATHERSEAL:  
 WHITE     BROWN

**HINGE/D\* PULL/HANDLE HARDWARE FINISH**

POLISHED BRASS  
 OIL RUBBED BRONZE  
 BRUSHED STAINLESS STEEL

**SURFACE BOLT\* HARDWARE FINISH**

BRIGHT GOLD ALUM.  
 OIL RUBBED BRONZE  
 BRUSHED STAINLESS STEEL  
 \* MOUNTED TO INTERIOR FACE OF DOOR STILES

REVIEWED, CHECKED AND APPROVED AS DRAWN OR MODIFIED  
 RE-SUBMIT AS NOTED  
 NOT IN COMPLIANCE WITH SPECIFICATIONS REQUIRED

AUTHORIZATION \_\_\_\_\_ DATE \_\_\_\_\_

PRINT NAME \_\_\_\_\_

VISTA POINTE USES ASCENT SERIES PANELS. BOTTOM RAIL IS 2" STD. UNLESS OTHERWISE SPECIFIED.

N.F.D. = NET FRAME DIMENSION  
 (T) = TEMPERED GLASS

ALL ELEVATIONS ARE VIEWED FROM THE EXTERIOR UNLESS NOTED OTHERWISE.



1433 N. TECH BLVD., GILBERT, AZ 85233  
 Ph: (480) 998-3940 \* Fax (480) 998-3941  
 Toll Free (866) 998-3942

COPYRIGHT 2008.  
 THE DRAWINGS, DETAILS AND INFORMATION CONTAINED HEREIN ARE THE SOLE PROPERTY OF VISTA POINTE ARCHITECTURAL SYSTEMS AND SHALL NOT BE REPRODUCED, COPIED OR DISCLOSED IN PART OR IN WHOLE, WITHOUT WRITTEN PERMISSION FROM AN AUTHORIZED AGENT OF VISTA POINTE ARCHITECTURAL SYSTEMS. ALL RIGHTS RESERVED.

CUSTOMER: \_\_\_\_\_

PROJECT: \_\_\_\_\_

CONTRACT NO: \_\_\_\_\_

REV. #	DATE	BY	DESCRIPTION

Date: 12/12/08  
 Drawn By: GWN  
 Checked By: DS  
 Scale: 8" = 1'-0"    Number of Sheets: \_\_\_\_\_    Sheet **WD1**

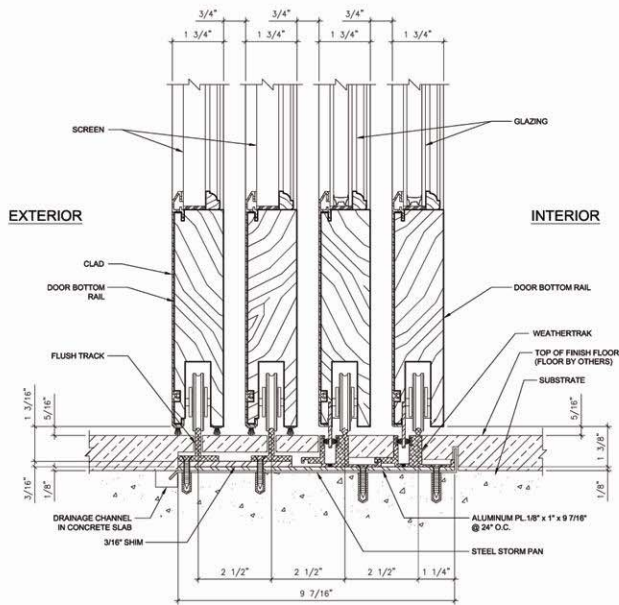

1 FLUSH TRACK & WEATHERTRAK - 4 TRACK SYSTEM  
 SCALE: 8" = 1'-0"

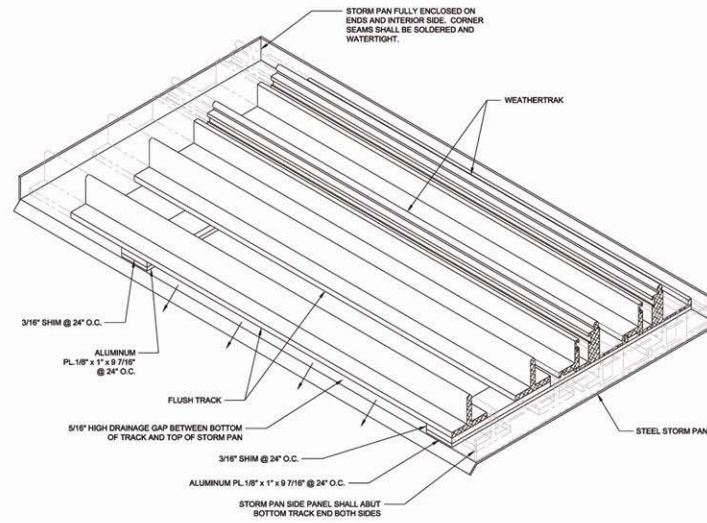

NOTE: DOOR PANELS AND FINISH FLOOR NOT SHOWN IN ISOMETRIC VIEW FOR CLARITY

2 FLUSH TRACK & WEATHERTRAK - ISOMETRIC VIEW  
 SCALE: 8" = 1'-0"

ROUGH OPENING (R.O.) THE SUGGESTED R.O. IS 3/8" LARGER AROUND THE PERIMETER THAN THE NET FRAME DIMENSION (NFD) SHOWN IN THIS DRAWING.

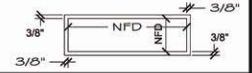

**EXTERIOR DOOR SPECIES & GLAD COLOR**

WOOD SPECIES: \_\_\_\_\_  
 PANEL CLAD COLOR: \_\_\_\_\_  
 GLASS: \_\_\_\_\_  
 EAGLE STD SPACER BAR COLOR: \_\_\_\_\_  
 DOOR THICKNESS: \_\_\_\_\_  
 THRESHOLD COLOR:  
 ALUM. CLEAR     BRONZE ANODIZED  
 Q-LON WEATHERSEAL:  
 WHITE     BROWN

**HINGE/D\* PULL/HANDLE HARDWARE FINISH**

POLISHED BRASS  
 OIL RUBBED BRONZE  
 BRUSHED STAINLESS STEEL

**SURFACE BOLT\* HARDWARE FINISH**

BRIGHT GOLD ALUM.  
 OIL RUBBED BRONZE  
 BRUSHED STAINLESS STEEL  
 \* MOUNTED TO INTERIOR FACE OF DOOR STILES

REVIEWED, CHECKED AND APPROVED AS DRAWN OR MODIFIED  
 RE-SUBMIT AS NOTED  
 NOT IN COMPLIANCE WITH SPECIFICATIONS REQUIRED

AUTHORIZATION \_\_\_\_\_ DATE \_\_\_\_\_

PRINT NAME \_\_\_\_\_

VISTA POINTE USES ASCENT SERIES PANELS. BOTTOM RAIL IS 2" STD. UNLESS OTHERWISE SPECIFIED.

N.F.D. = NET FRAME DIMENSION  
 (T) = TEMPERED GLASS

ALL ELEVATIONS ARE VIEWED FROM THE EXTERIOR UNLESS NOTED OTHERWISE.



1433 N. TECH BLVD., GILBERT, AZ 85233  
 Ph: (480) 998-3940 \* Fax (480) 998-3941  
 Toll Free (866) 998-3942

COPYRIGHT 2008.  
 THE DRAWINGS, DETAILS AND INFORMATION CONTAINED HEREIN ARE THE SOLE PROPERTY OF VISTA POINTE ARCHITECTURAL SYSTEMS AND SHALL NOT BE REPRODUCED, COPIED OR DISCLOSED IN PART OR IN WHOLE, WITHOUT WRITTEN PERMISSION FROM AN AUTHORIZED AGENT OF VISTA POINTE ARCHITECTURAL SYSTEMS. ALL RIGHTS RESERVED.

CUSTOMER: \_\_\_\_\_

PROJECT: \_\_\_\_\_

CONTRACT NO: \_\_\_\_\_

REV. #	DATE	BY	DESCRIPTION

Date: 12/12/08  
 Drawn By: GWN  
 Checked By: DS  
 Scale: 8" = 1'-0"    Number of Sheets: 1    Sheet **WD1**

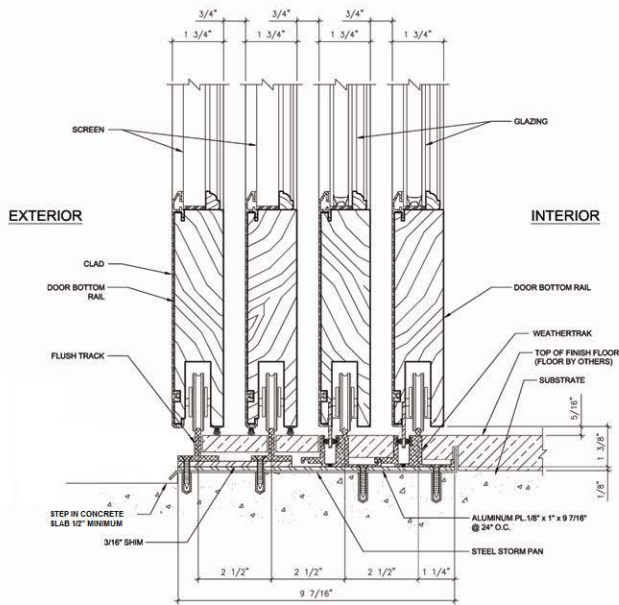

1 FLUSH TRACK & WEATHERTRAK - 4 TRACK SYSTEM  
 SCALE: 8" = 1'-0"

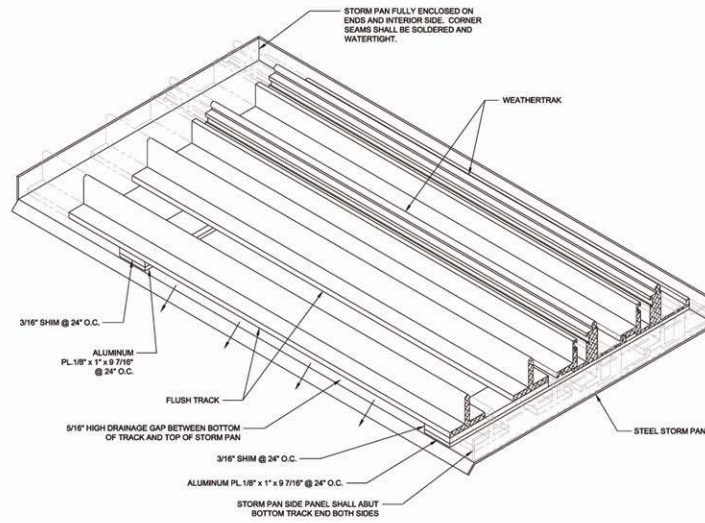

NOTE: DOOR PANELS AND FINISH FLOOR NOT SHOWN IN ISOMETRIC VIEW FOR CLARITY

2 FLUSH TRACK & WEATHERTRAK - ISOMETRIC VIEW  
 SCALE: 8" = 1'-0"