

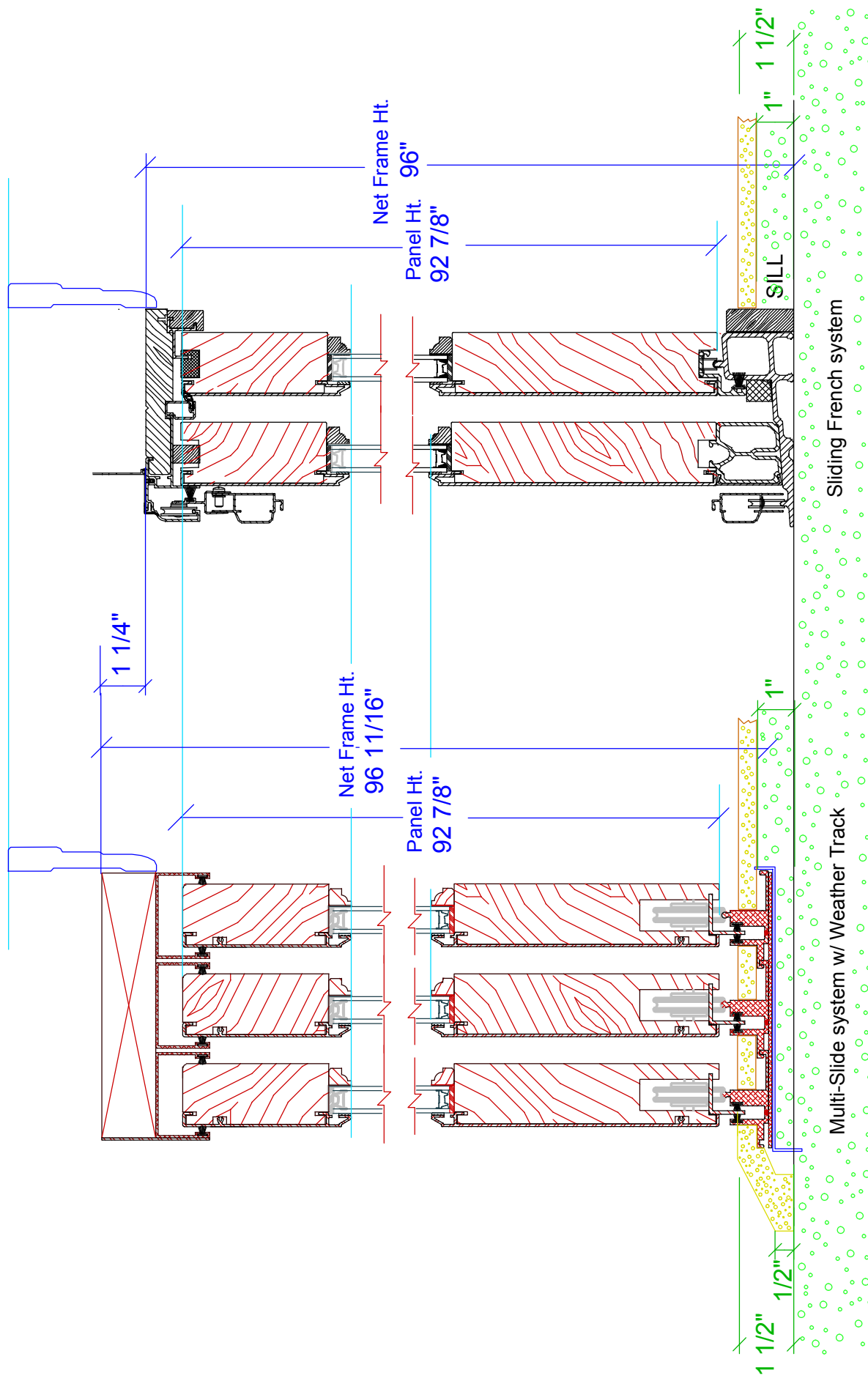

# PBS / Eagle Detail: Multi-Slide compared to Sliding French (Using Std. Ht. Ascent French door panels)



Panel / Horizontal Daylight Edge Alignment requires setting the multi-slide door 1/2" higher than French Sliding Door. (Shown here w/ Std 8-0 panel Ht. It also requires some 'creative' flooring / sill nose (by others) with water evacuation channel at base of sill pan to address off-set.